



CE
ISO9001



Rated voltage
 $U_i = 690 \text{ V a.c./d.c.}$



Material
PS polystyrene
thermoplastic

JUNCTION BOX WITH TERMINAL

SE-9065Z



TECHNICAL DETAILS

Rated insulation voltage	$U_i = 690 \text{ V a.c./d.c.}$
Tightening torque for terminal	1,5 Nm
Degree of protection	IP 55 (ESM)
Degree of protection	(see cable entry system LES) IP 65
Material	PS polystyrene thermoplastic
Width	139 mm
Height	119 mm
Depth	70 mm
Weight	0,272 kg
in accordance with	IEC 60 670-22
Application area	Suitable for indoor installation and outdoor installation, protected against weather
Resistant to occasional cleaning procedures	Resistant to occasional cleaning procedures (direct jet) with high-pressure cleaner without additives, water pressure; max. 100 bar, water



Ambient temperature	Average value over 24 hours + 35 C , maximum value + 40 C , minimum value - 25 C
Relative humidity	50 at 40 C , short-time , 100 at 25 C
Fire protection in the event of internal faults	Demands placed on electrical device from standards and laws minimum requirements - Glow wire in accordance with IEC 60 695-2-11, -650 C for boxes and cable glands -850 C for parts of insulating material necessary to retain current carrying parts in position
Burning behaviour	Glow wire test IEC 60 695-2-11: 750 C , UL Subjects 94; V-2, flame-retardant, self-extinguishing
Degree of protection against mechanical load	IK07 (2 Joule)
Toxic behaviour	halogen-free, silicone-free, " halogen-free" in accordance with the examination of the cables and insulated wires - corrosiveness of fumes - as per IEC 60 754-2

DIMENSION

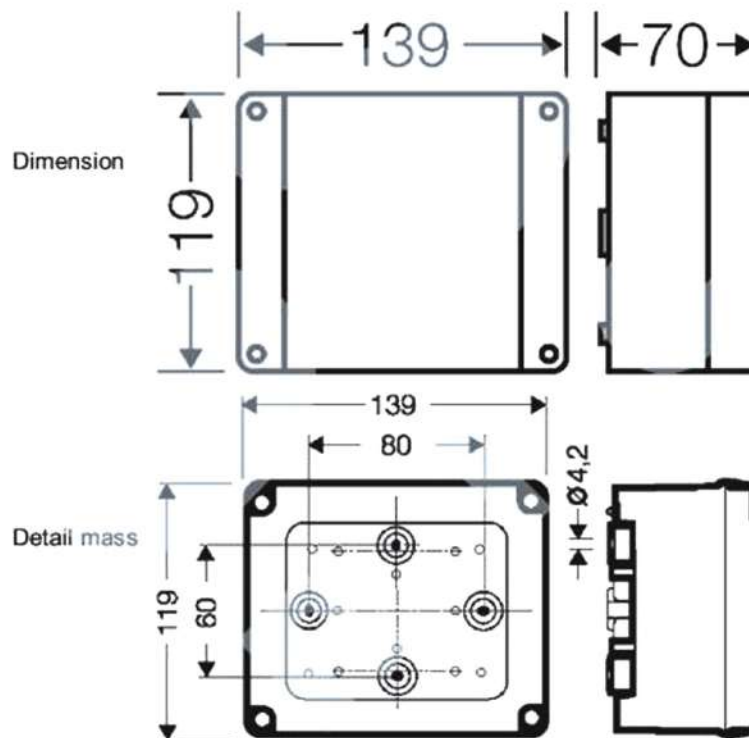

CHARACTERISTICS

- **With terminal**
- **5-pole per pole 4 / 2.5 mm sol, 4 / 4 mm sol, 3 / 6 mm sol, 2 / 10 mm sol**
- **included cable entry ; 4 ESM 20, Sealing range 6-13 mm**
- **for normal environment and protected outdoor**
- **colour : Grey , RAL 7035**