



CE  
ISO9001



contact material  
copper



Voltage  
600V

# BATTERY TERMINAL 350A



## TECHNICAL DETAILS

RATED CURRENT (A)	350A
RATED VOLTAGE (V)	600V
(AWG)/CONTACT BARREL WIRE SIZE	1/0 2/4AWG (53.5MM - 67.4MM)
AVERAGE CONTACT RESISTANCE	0.05M
WITHSTAND VOLTAGE	2200V(DC)
INSULATION RESISTANCE	500M
NO LOAD(CONTACT/DISCONNECT CYCLES)	TO 10,000
UNDER LOAD(HOT PLUG 250 CYCLES @120V	75A
AVERAGE INSERTION FORCE	130N
FIRE RATING OF HOUSING	UL94 V-0
OPERATING TEMPERATURE RANGE	-20 TO 105
CONTACT MATERIAL	COPPER/PLATING SILVER



## DIMENSION

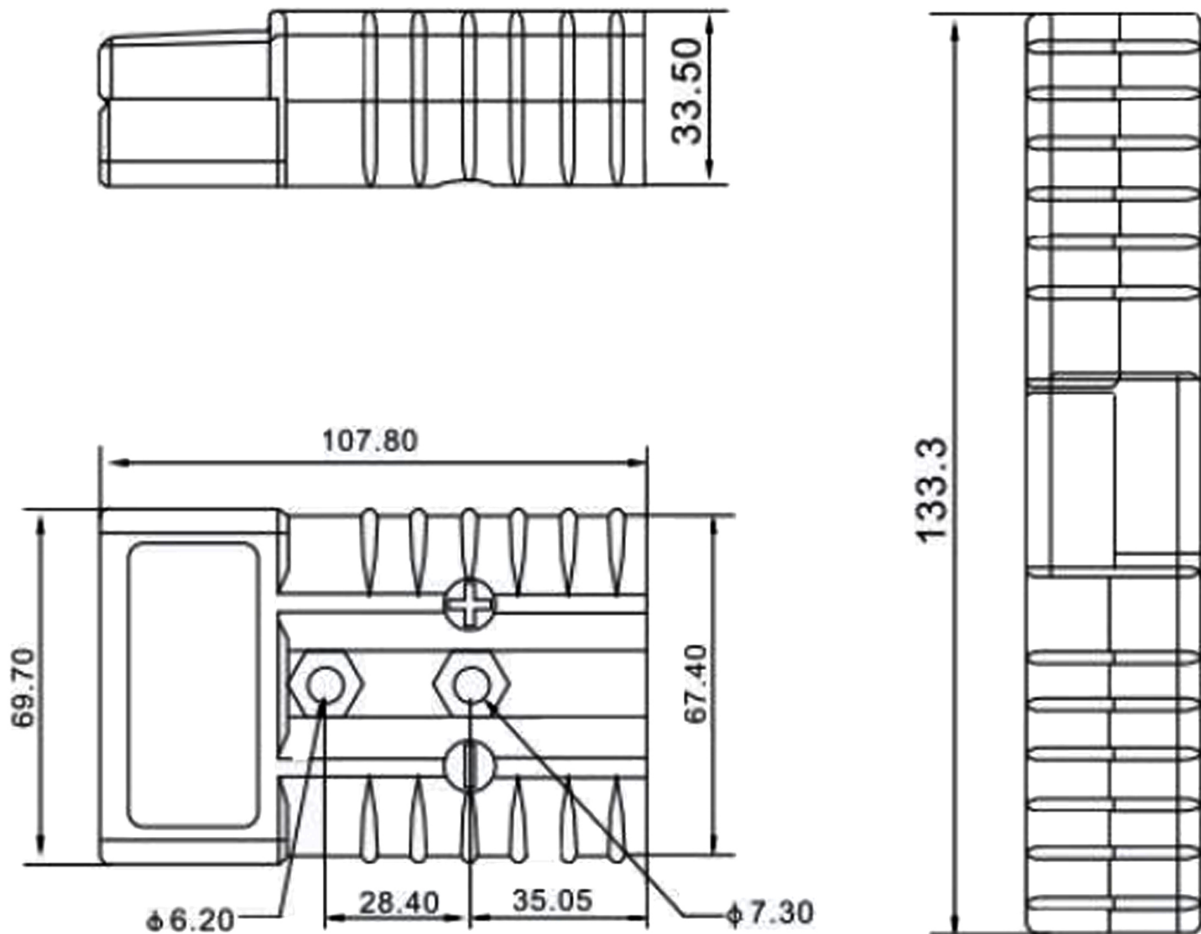

## CHARACTERISTICS

**USED IN HIGH-CURRENT INTER-PLUGS AND ACCESSORIES, RAILWAY, MINING, TELECOMMUNICATION, LITHIUM BATTERY CHARGING, ELECTRIC FORKLIFTS, SIGHTSEEING CARS AND VARIOUS DC EQUIPMENT AND HIGH -CURRENT PLACES**